

ALSTEEL 2 Rail Fence Profile

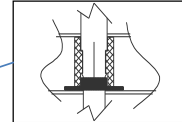
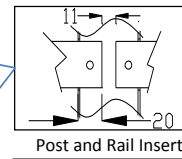
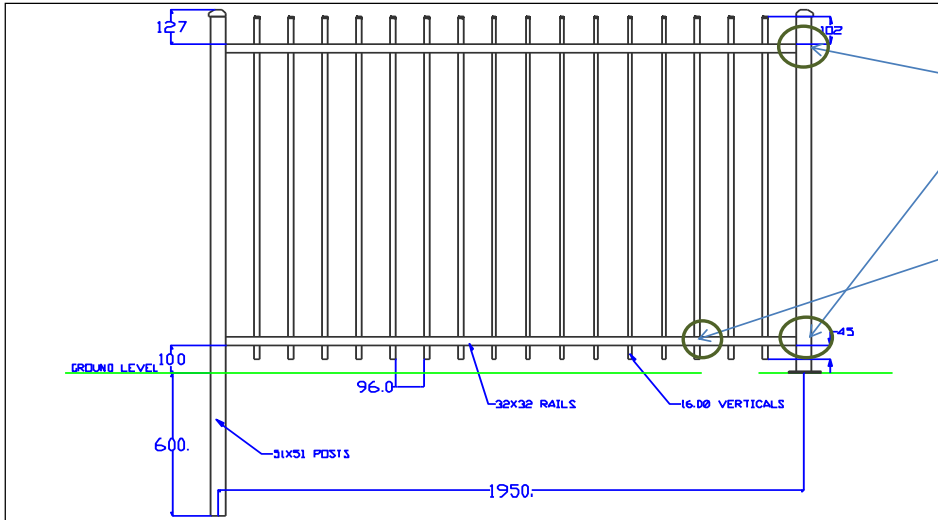

	Heights
Picket Heights	600 mm
	900 mm
	1000 mm
	1250 mm
	1500 mm
NB: Pool fencing must be above 1.2mtrs in height.	

Standard Panel Sizing's		
Alsteel	Rail or Panel length	Post centre to Post centre
Half Panel	1038mm	1050mm
Standard Panel	1939mm	1950mm
Long Panel	2390mm	2400mm
Picket spacing's are 112mm centres with 96mm clearance between pickets		
NB: All panel lengths can be cut to fit your installation requirements		

Specifications	
Posts	51mm square by 1.6mm (50.8x50.8mm)
Rails	31 mm square by 1.6 mm (31.8x31.8mm)
Pickets (verticals)	16 mm diameter by 1.2 mm (15.9mm)

The base product for Alsteel Tubular Fencing is "GALVSTEEL" coil G250 Z275 manufactured in New Zealand by New Zealand Steel.

Styles	Styles				
	Rod	Royal	Hoop	Spear	Flat
	Can be configured as a level top, high low or arched top.	An ageless classic that is great by itself or compliments mixed with another style	This product will not rake to contours	NB: for safety purposes, recommend not to be used on fences under 1800mm high	The original Flat top fence

Due to the mill process on forming the tube, the end product has a tensile strength to G300 Grade

Structural Grade	NZS 3441 Base Grade	Yield Stress MPA min.	Tensile Strength Mpa min.	Elongation % on 50mm min.	Longitudinal bend test Radius of bend
	G300	300	370	20	0.5t

t = thickness of test piece

All products can be provided with either a powder coated or a Galvanised finish to meet your design requirements

Most styles can be mixed and matched to create your own design. Long pickets can be ordered to protect from intrusion where drains or dips may exist.

See www.fencingsystems.co.nz for a gallery of previously installed fences and ideas

Your local ALSTEEL Fencing Distributor is:

Premium Alsteel tubular fencing is provided with a standard 5 year material and manufacture warranty. See web site for terms and conditions

Call 0800 622 622 for a FREE quote

